

**Presented By:** Candela Corporation  
 Contact Phone: 800-922-9226  
 Contact E-mail: sales@candelacorp.com

Customer Name:  
 Project Name:  
 Fixture Type:



GE  
 Lighting

**26709 - 1003**

GE B6 - Automotive; Marine

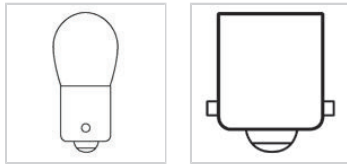
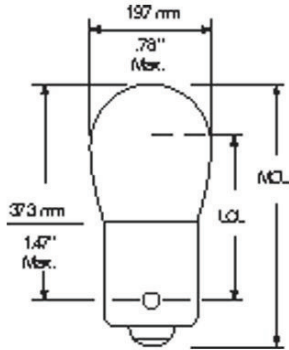

**GENERAL CHARACTERISTICS**

Lamp Type	Miniature - B Shape
Bulb	B6
Base	Single Contact Bayonet (BA15s)
Filament	C-6
Rated Life (MIN)	12.0 h
Rated Life (Vert)	200.0 h
Rated Life (NOM)	200.0 h
Rated Life (Hor)	12.0 h
Atmosphere	Gas-filled
Primary Application	Marine;Back up;Dome;Glove Box;High Mount Stop;Instrument, General;License Plate;Map;Step/Courtesy;Tail;Trunk/Cargo Area;Turn Signal, Rear;Under Hood

**PHOTOMETRIC CHARACTERISTICS**

Initial Lumens (Vert)	189.0
Initial Lumens (NOM)	189.0
Initial Lumens (Hor)	15.75
Nominal Initial Lumens per Watt (NOM)	15.75
Center Beam Candlepower (CBCP) (NOM)	189.0
Mean Spherical Candlepower (MSCP) (NOM)	15.0

**ELECTRICAL CHARACTERISTICS**

Wattage (NOM)	12.0
Voltage (MIN)	200.0
Voltage (NOM)	12.8

**DIMENSIONS**

Maximum Overall Length (MOL) (NOM)	1.750 in(44.4 mm)
Bulb Diameter (DIA) (NOM)	0.750 in(19.0 mm)
Light Center Length (LCL) (NOM)	1.060 in(26.9 mm)

**PRODUCT INFORMATION**

Product Code	26709
Description	1003
ANSI Code	1003
Standard Package	Case
Standard Package GTIN	20043168267094
Standard Package Quantity	50
Sales Unit	Unit
No Of Items Per Sales Unit	1
No Of Items Per Standard Package	50
UPC	043168267090